

Byron Bay

Sotheby's

INTERNATIONAL REALTY



6/31 Hayters Drive Suffolk Park NSW

4 🚗 3 🚗 2 🚗

A showcase of exquisite luxury and architectural finesse on over 875sqm of internal space including a self-contained studio, this stunning residence captures the essence of Byron Bay's iconic lifestyle. Set on a generous 875.9sqm block and elevated with a stunning backdrop of tranquillity, it's only a short bike ride away from shops and beaches.

Interstate buyers please note: We offer complimentary private airport pick up and drop off for fly in and fly out buyers. Otherwise, private FaceTime viewings are also available. Please call Will or Peter to arrange.

- Expertly crafted and beautifully appointed home completed in 2020
- Adaptable floor plan featuring a self-contained studio with

[For full version visit the website](https://www.byronbaysir.com.au)

Type : House
Price : EOI guide on request, close Thurs 24th Oct 5pm
Land Size : 875.9 sqm
View : <https://www.byronbaysir.com.au/sale/nsw/northern-rivers/suffolk-park/residential/house/8132635>



Will Phillips
02 6610 8892



Peter Randall
02 6610 8892

<https://www.byronbaysir.com.au>

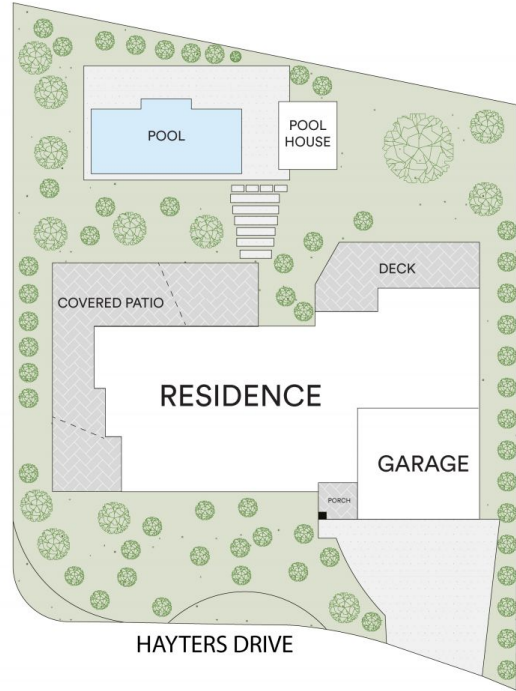

INT : 307m²
 EXT : 88m²
 LAND : 876m²

Scale in metres. Indicitive only. Dimensions are approximate. All information contained herein is gathered from sources we believe to be reliable. However we cannot guarantee its accuracy and interested persons should rely on their own enquiries.

Unit 6/31 Hayters Drive, Suffolk Park 2481

Byron Bay | **Sotheby's**
 INTERNATIONAL REALTY

