



## 4 Meadows Close Bangalow NSW

4 3 2

Positioned in a desirable Bangalow enclave adjacent to the green rolling hills of the Byron Shire hinterland, this 807m<sup>2</sup> property effortlessly fuses contemporary elegance with family functionality. The exceptional floorplan has been carefully considered, featuring an expansive open-plan living and dining area connecting easily to the large landscaped backyard with swimming pool. A luxurious master suite, custom kitchen and dedicated home office define the main living zone, while a modern self-contained one bedroom studio promises easy upscale living for guests, teens or extended family. Enriched with bespoke joinery and a cache of top-quality inclusions, it's a modern Bangalow classic just a 10 minute stroll to the main street.

Renowned for its boutique galleries, cafes and popular

[For full version visit the website](https://www.byronbaysir.com.au)

**Type** : House  
**Price** : \$ 2,150,000  
**Land Size** : 808 sqm  
**View** : <https://www.byronbaysir.com.au/sale/nsw/northern-rivers/bangalow/residential/house/8117270>



**Will Phillips**  
02 6610 9892



**Peter Randall**  
02 6610 9892

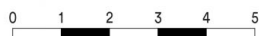
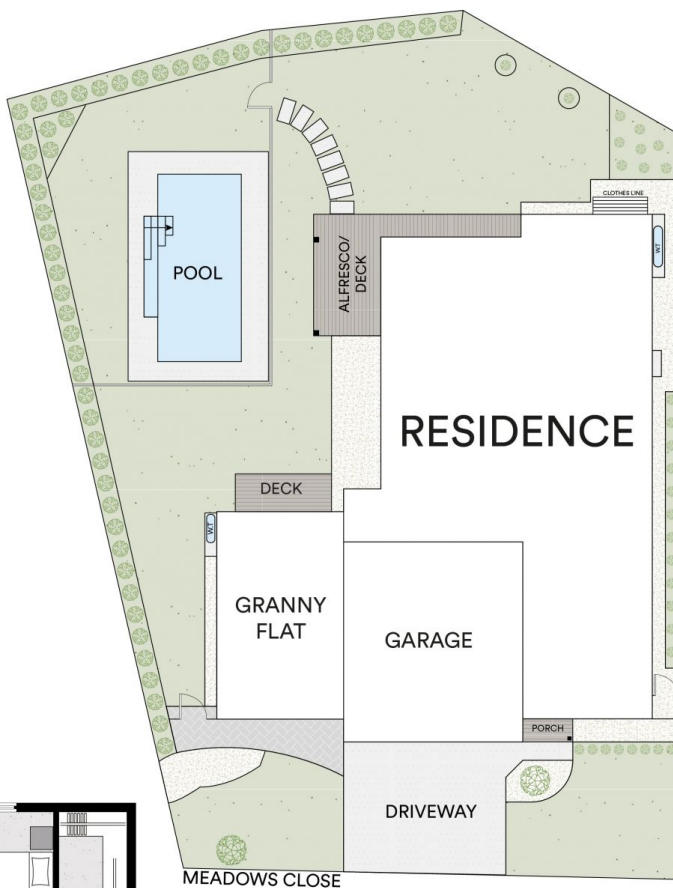

All information contained in this document is from sources we believe to be accurate, however we cannot guarantee its accuracy. Interested persons should make and rely on their own enquiries in relation to measurements, dimensions, layout, furniture and descriptions.

INTERNAL AREA : 272 M<sup>2</sup>  
EXTERNAL AREA : 27 M<sup>2</sup>  
LAND AREA : 807 M<sup>2</sup>